

- **Style: Simple**
- **Size: Micro case supports up to Micro-ATX MB**
- **Material: Steel & Tempered Glass**

Main Features

- **Connection** : Front I/O ports with 2 x USB 3.0 & 1 x USB 3.2 (Gen 2) Type C
- **Cooling Solution** : Pre-installed 140mm CT140 Fan x 2
- **Support** : Supports 420mm AIO cooling solutions



Specification

Model	The Tower 300	The Tower 300 Snow
P/N	CA-1Y4-00S1WN-00	CA-1Y4-00S6WN-00
Case Type	Micro Tower	
Chassis Dimension (H*W*D)	551 x 342 x 281 mm (22.5 x 14 x 11.5 inch)	
Net Weight	8.3 kg / 18.3 lbs.	
Side Panel	3mm Tempered Glass x 3	
Color	Black	White
Material	SPCC	
Cooling System	Top(exhaust): 140 x 140 x 25 mm CT140 fan (1500rpm, 30.5 dBA) x 2	
Drive Bays	3 x 3.5" or 3 x 2.5"	
Expansion Slots	4	
Motherboards	6.7" x 6.7" (Mini ITX), 9.6" x 9.6" (Micro ATX)	
I/O Port	USB 3.2 (Gen 2) Type-C x 1, USB 3.0 x 2, HD Audio x 1	
PSU	Standard PS2 PSU (optional)	
Fan Support	Top: 2 x 120mm, 1 x 120mm 2 x 140mm, 1 x 140mm Right Side: 3 x 120mm, 2 x 120mm, 1 x 120mm 3 x 140mm, 2 x 140mm, 1 x 140mm Rear: 2 x 120mm, 1 x 120mm 2 x 140mm, 1 x 140mm Power Cover: 1 x 120mm 1 x 140mm	
Radiator Support	Right Side(AIO): 1 x 360mm, 1 x 240mm, 1 x 120mm 1 x 420mm, 1 x 280mm, 1 x 140mm	
Clearance	CPU cooler height limitation: 210mm VGA length limitation: 280mm(With power cover) 400mm(Without power cover) PSU length limitation: 220mm	

Packaging

Package Information	The Tower 300	The Tower 300 Snow
EAN Code	4711475641051	4711475641068
UPC Code	841163091067	841163091074
N.W	8.3 kg / 18.3 lbs.	
G.W	10.3 kg / 22.71 lbs.	
Carton Size (L x W x H)	411 x 358 x 640 mm / 16.18 x 14.09 x 25.2 inch	
Cuft	3.32	
Container	w/o pallet	
20'	323 pcs	
40'	662 pcs	
40' HQ	734 pcs	



Appearance – Black version



Angle view



Left Side view



Front view



Right Side view



Internal Structure

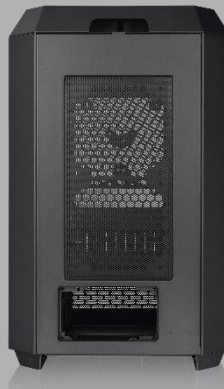

Rear view



Top view



Bottom view

Appearance – Snow version

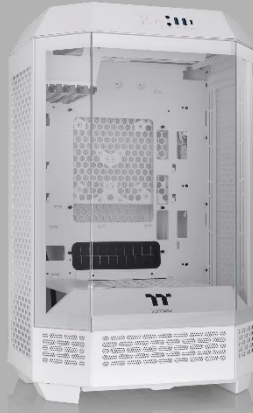

Angle view

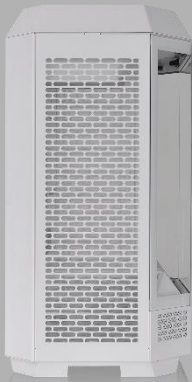

Left Side view

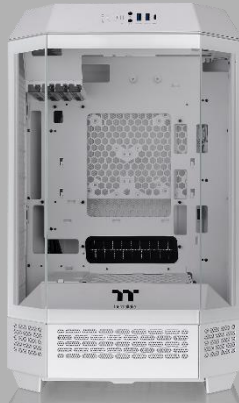

Front view



Right Side view

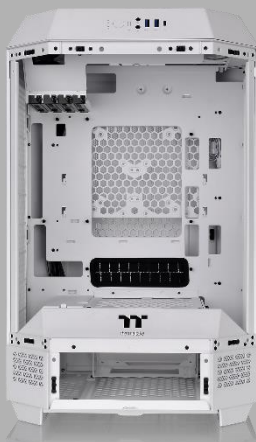

Internal Structure

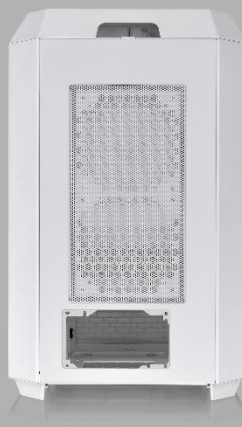

Rear view



Top view



Bottom view

Clearance



Maximum supports up
to 140mm fan x 8

Maximum AIO radiator
supports up to 420mm



Unique Design



Two front metal panels for customized installation.



✘ 3.9 inch LCD Screen Kit is not included

Structure (External)



USB 3.2 (Gen 2) Type-C x 1

USB 3.0 x 2

HD Audio



Easy-to Remove

Structure (Internal)



Two 140mm Top Fans

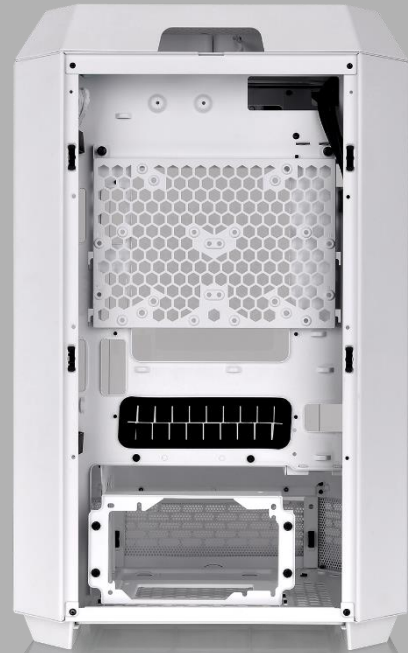

Supports ATX PSU

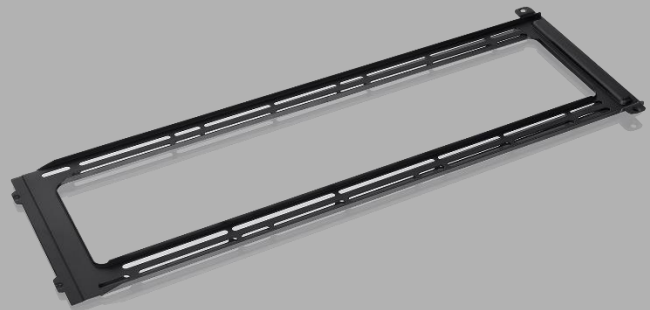

Right Side Bracket
for Radiator/Fan Installation

Structure (Internal)

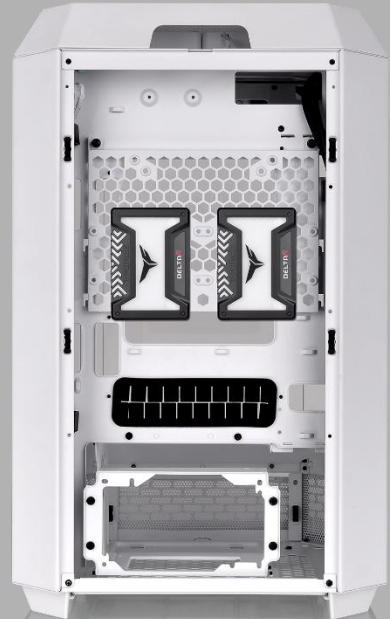

3 x 2.5"



3 x 3.5"

Structure (Internal)

Top filter

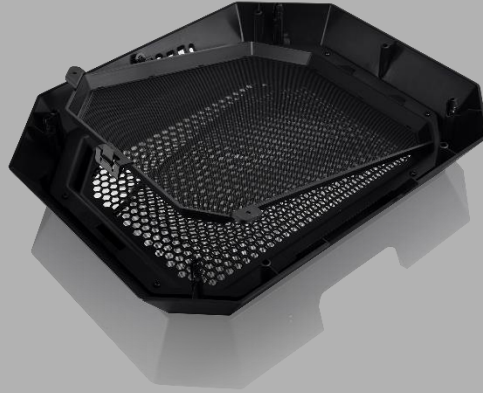

Front and Side filters

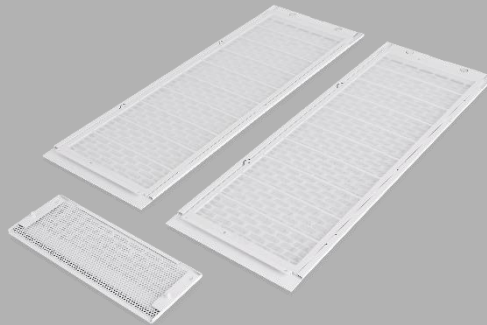

Bottom filter



Pre-installed CT140 Fan



Pre-installed two hydraulic bearing 140mm **CT140** fans which can effectively lower the operation noise and enhance the thermal efficiency.



Black Version

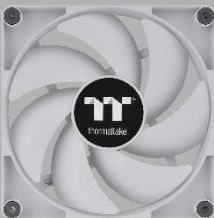

Snow Version

SPEC for Case **CT140** fans

-Fan Speed: 500~1500 RPM

-Max. Fan Airflow: 77.37 CFM

- Max. Fan Air Pressure: 2.3 mm-H2O

- Fan Noise Level: 30.5 dBA

-Fan Bearing: Hydraulic bearing



Thermaltake The Tower 300 Micro Tower Case

Exploded View

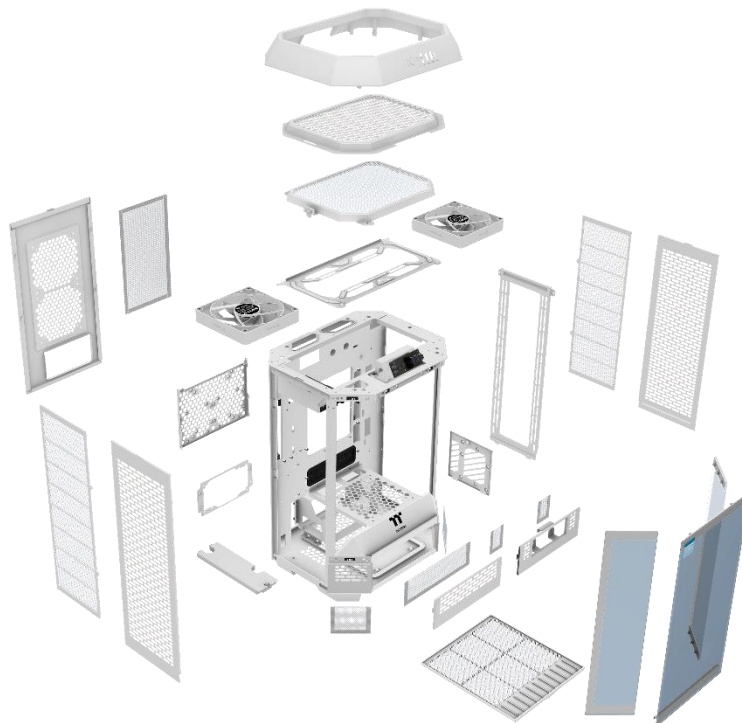
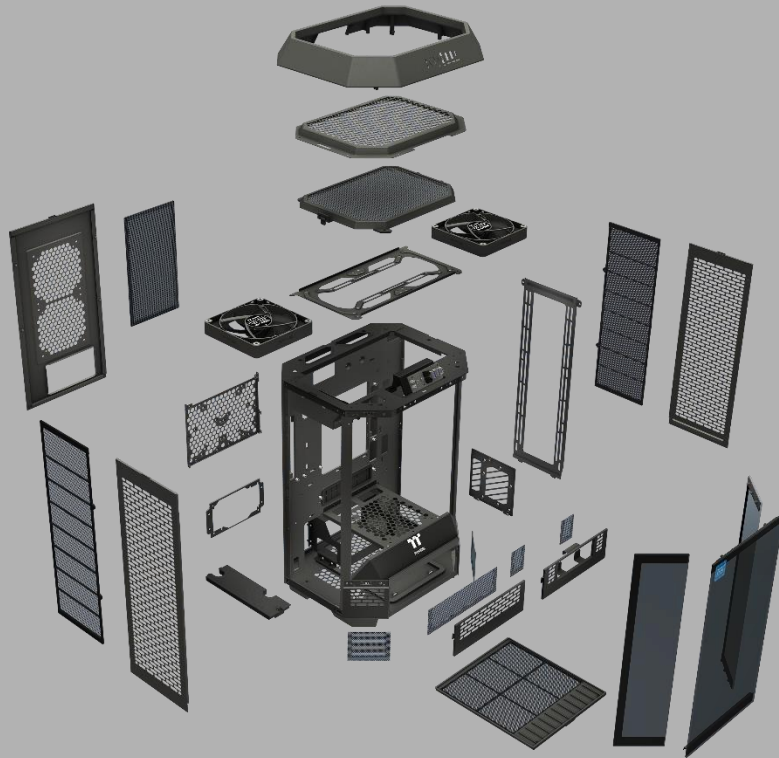

Compatibility List

Fan Compatibility List			
	120mm	140mm	200mm
Top	2	2	-
Right Side	3	3	-
Rear	2	2	-
PSU Cover	1	1	-

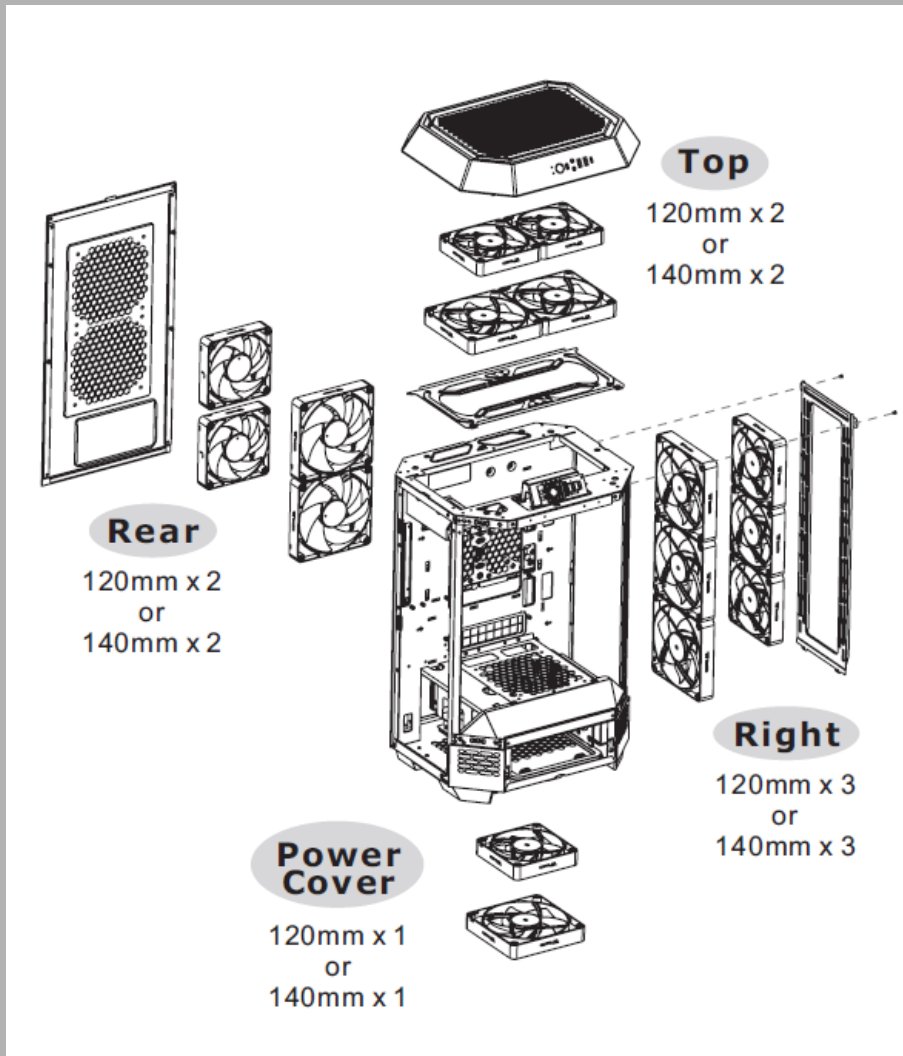

All-in-One Compatibility

All-in-One Compatibility List

	120mm	240mm	360mm	140mm	280mm	420mm
Top	-	-	-	-	-	-
Right Side	●	●	●	●	●	●
Rear	-	-	-	-	-	-

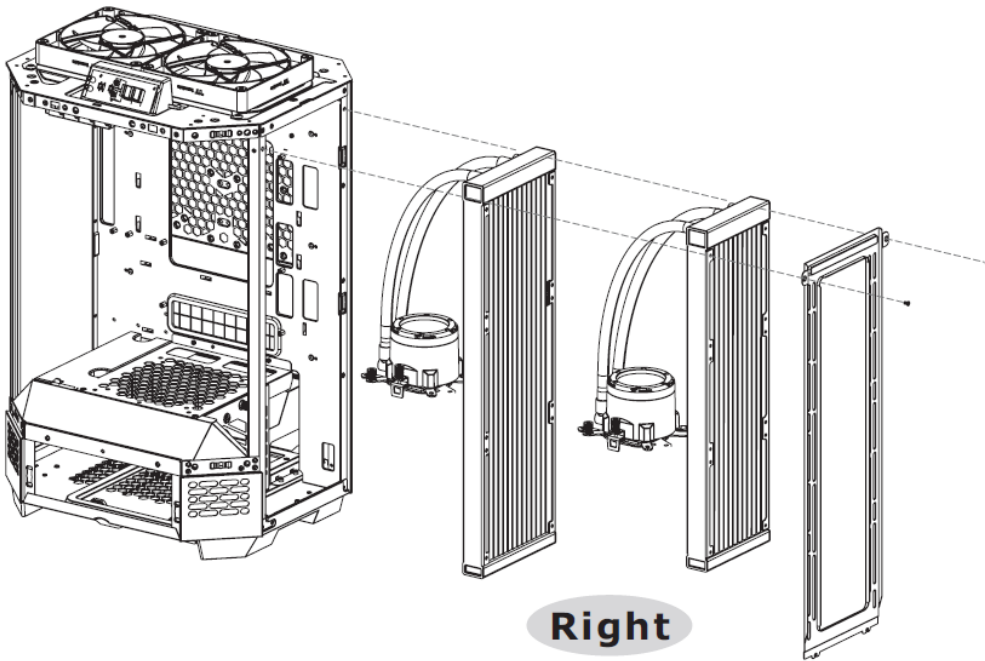

Right

360mm x 1
or
420mm x 1